



3 Sandstone Avenue
Walton, Chesterfield, S42 7NS
Offers Over £375,000

3 Sandstone Avenue

Walton, Chesterfield, S42 7NS

Situated in the highly sought after Chesterfield suburb of Walton, within walking distance to local amenities, Somersall Park, the best local schools and on the doorstep of some stunning countryside, is this attractive, deceptively spacious, practically designed and well presented 4 bedroom detached family home.

Offering 1140 sqft of accommodation over 2 storeys, the property features a stylish kitchen with breakfast bar, 3 reception rooms including the family lounge, a dining room and adjoining conservatory, 4 good sized bedrooms, 2 bathrooms including the master en-suite shower room and a fantastic plot with landscaped gardens to the front and rear, and a large block paved driveway providing off road parking for multiple vehicles.

The ground floor comprises; entrance hallway, ground floor WC, bay-fronted family lounge, formal dining room with an adjoining conservatory and a stylish kitchen with integrated oven, gas hob and breakfast bar.

The first floor comprises; family bathroom with bath and overhead shower, 4 good sized bedrooms including the master bedroom with en-suite shower room.

Dales & Peaks ForwardMove
please read





Floor Plan

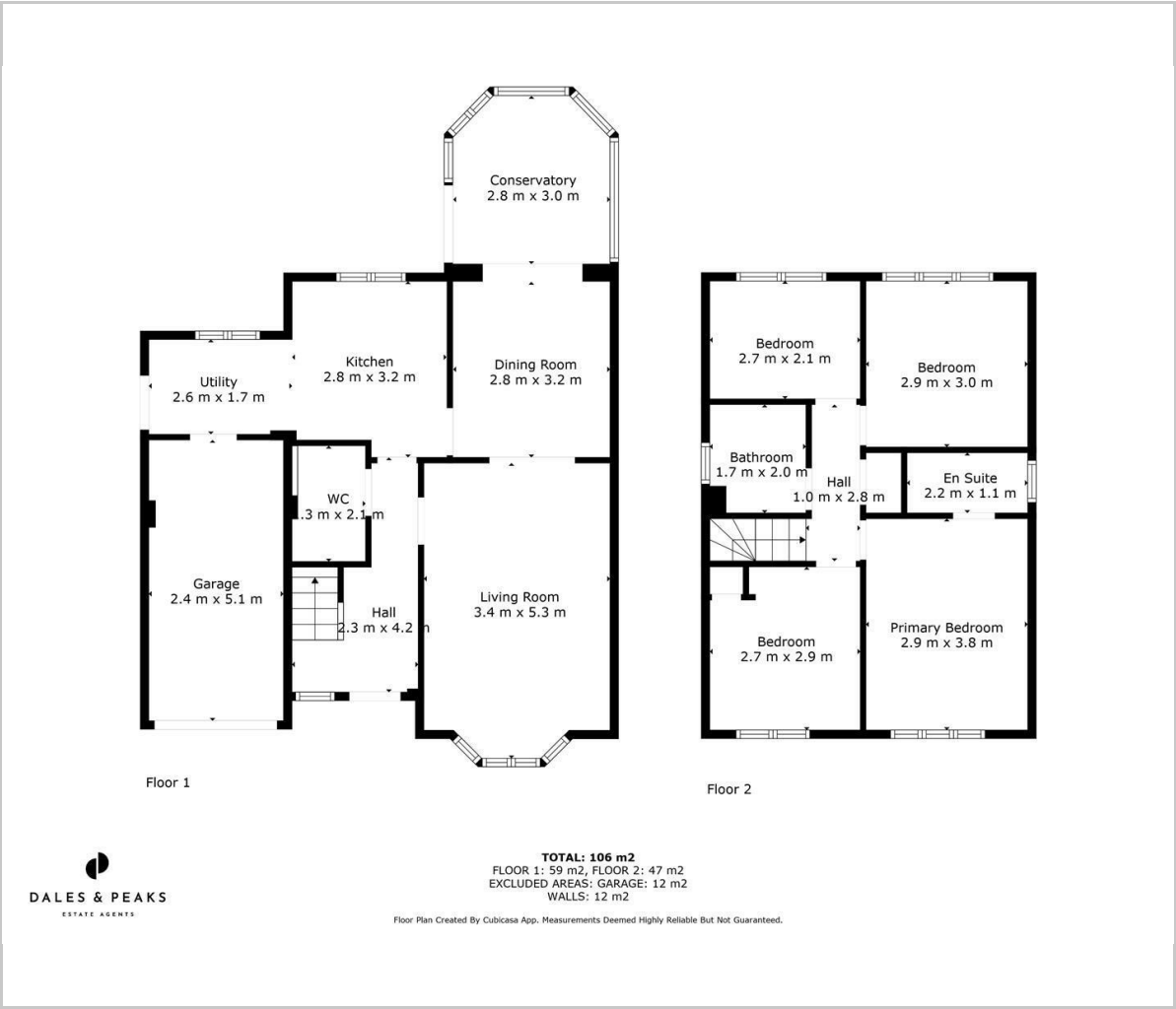

Viewing

Please contact our Chesterfield Office on 01246 567540 if you wish to arrange a viewing appointment for this property or require further information.

These particulars, whilst believed to be accurate are set out as a general outline only for guidance and do not constitute any part of an offer or contract. Intending purchasers should not rely on them as statements of representation of fact, but must satisfy themselves by inspection or otherwise as to their accuracy. No person in this firms employment has the authority to make or give any representation or warranty in respect of the property.

Area Map

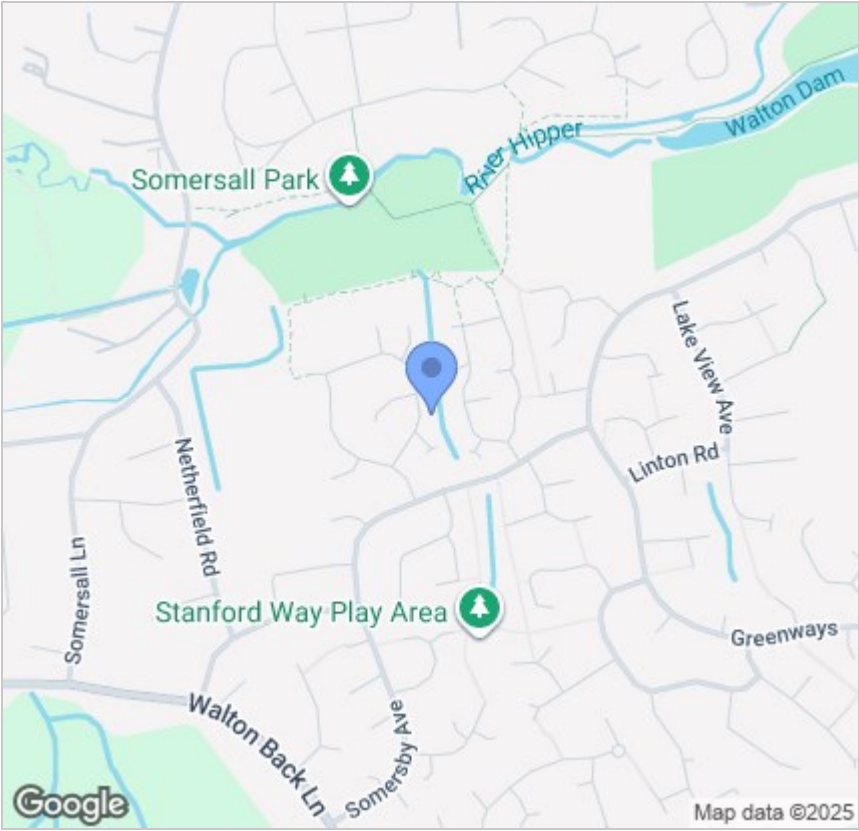

Energy Efficiency Graph

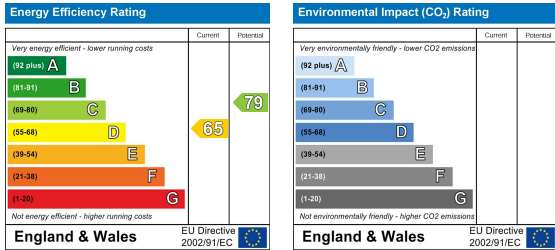

131 Chatsworth Road, Chesterfield, Derbyshire, S40 2AP
T: 01246 567540



E: info@dalesandpeaks.co.uk
www.dalesandpeaks.co.uk